



CAD·CAM

Product
Catalog
2 0 1 7

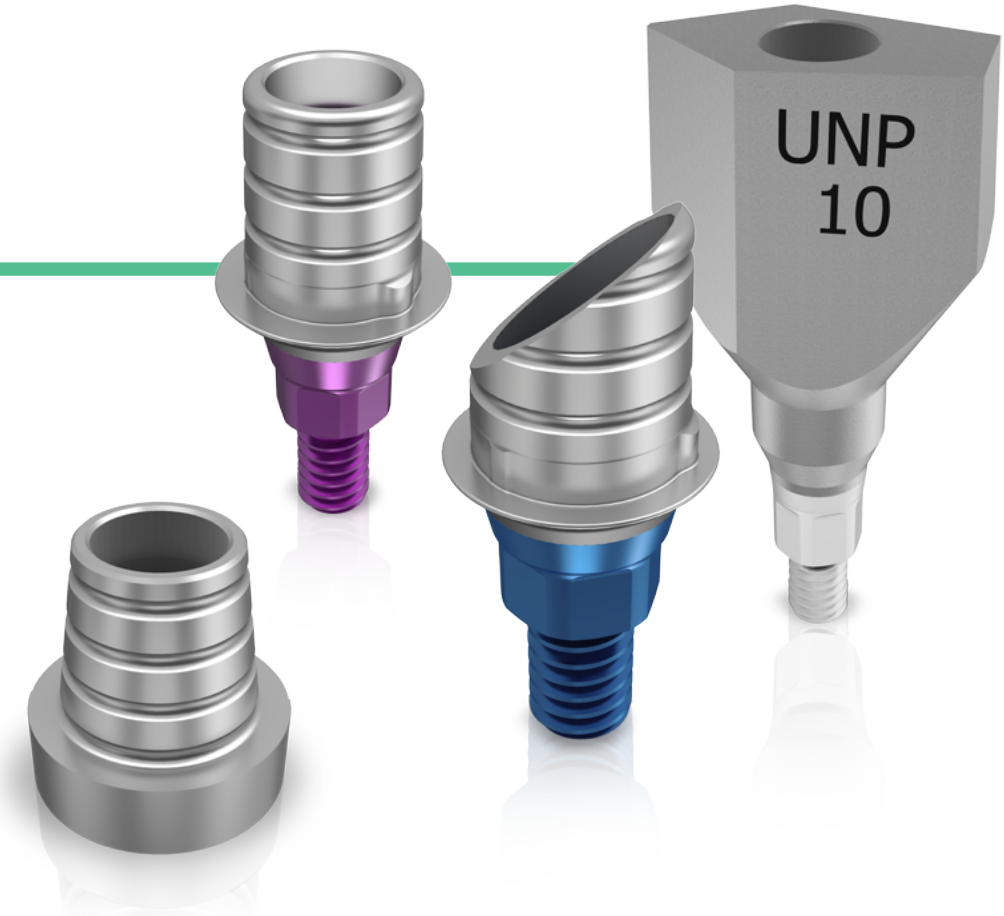

Table of Contents

CAD CAM Overview	3
CloseFit™ UNP	6-7
CloseFit™ NP	8-9
CloseFit™ RP	10-11
CloseFit™ WP	12-13
RS - Standard Internal Hex	14-15
TMA - Multi Unit	16-17
Accessories	18-20
Digital Libraries	21
Index	22-23

CAD CAM Overview

Adin's CAD CAM components and digital libraries enable dentists and dental technicians to design and manufacture state-of-the-art restorations supported by Adin's implants, using current and up-to-date digital restoration processes. The variety of components ensure endless restorative options for treatment of single, partially, or full edentulous cases.



Scan Body

The Scan Body is a component used as a digital transfer for the Adin Digital -ViZ intraoral scanner, any other intraoral scanners or desktop scanners.

The unique geometry and texture of Adin's Scan Bodies optimize the effectiveness of scanning.

The Adin Scan Bodies are available for each of Adin's implant connection platforms and for Adin's TMA abutments – differing in height to accommodate all clinical scenarios.

Features

- Soild unique geometry and special design texture
- TI Alloy material for multi-use
- Innovative 3D Scan Body files for optimal matching and accuracy enabling 35μ technology
- Reusable- designed for use with both Desktop and Intraoral scanners
- Comes in two different heights for maximum comfort in the clinic and in the laboratory
- Suitable for various interocclusal distance
- Valid for scanning with or without scanning powder
- Retaining Screw is Included

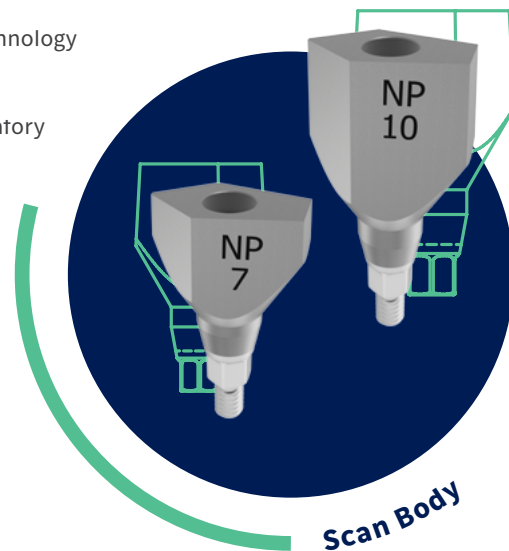

Ti Bases

A Ti base is used for the restorative supply of an implant.

For this purpose, a superstructure is cemented onto the Ti base and can be used as the abutment or directly bolted crown.

Ti Bases are connected to an implant for the adhesion of superstructure (abutment or crown) made of Zirconium and / or metal alloys such as CoCr to restore function and aesthetics in the oral cavity.

Ti base is intended for manufacturing a two-part restoration, comprising of Ti Base and superstructure (abutment or directly bolted crown).

Features

- Wide variations and angular structure for all platforms including the multi-unit interface
- Available with engaging (anti-rotation connection for single-unit restoration) and non-engaging variations (connection that allows rotation for multi-unit restorations)
- For all conical and internal Hex connections
- Supported two modes of use: screw retained and cement retained
- Retaining Screw is Included

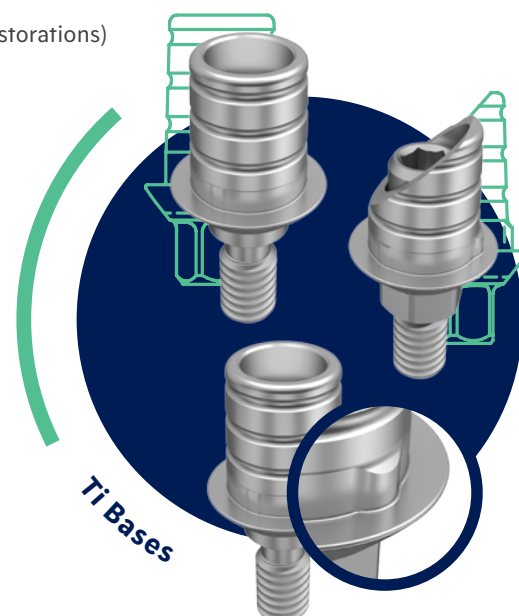

TMA Cylinder & Cementing Cone

TMA-MU Cementing Cone are used as Ti-Bases for cementing /gluing CAD/ CAM manufacturing of individual ceramic or metal two parts (hybrid) MU restorations (bridges).

Features

- Enable precise and long lasting contact between CAD CAM restoration and TMA-MU abutments
- Support cemented and screw retained restoration
- Support bridge (non-engaged) restorations
- Large cementing surface and grooves for high stability and best fit adhesion

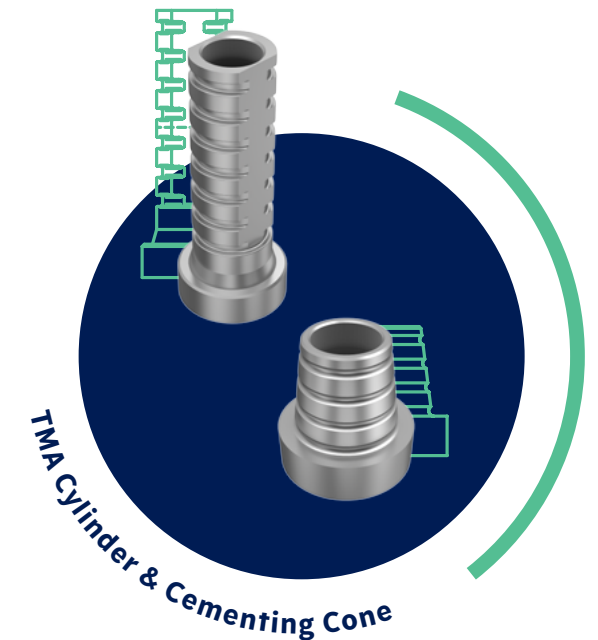

Ti Blanks

Pre-milled Adin Ti Blanks are used as a raw material for CAM fabrication of a single part (monolithic) titanium abutment. The production of the individual abutment is done digitally with CAD software.

Adin Ti Blanks abutments are intended for use with dental implants as a support for single or multiple tooth prostheses in the maxilla or mandible of a partially or fully edentulous patient.

Features

- Titanium Blanks, for using as customized abutments, are available for all Adin's implant platforms, in different sizes of Ø=11.5mm and Ø=15.8mm to accommodate all clinical needs
- Adin's Titanium Blanks are Medentika PreFace® standard compatible
- Material: Titanium (Ti 6Al 4V ELI)
- As customized abutment, the final milled part needs no additional manual manipulation

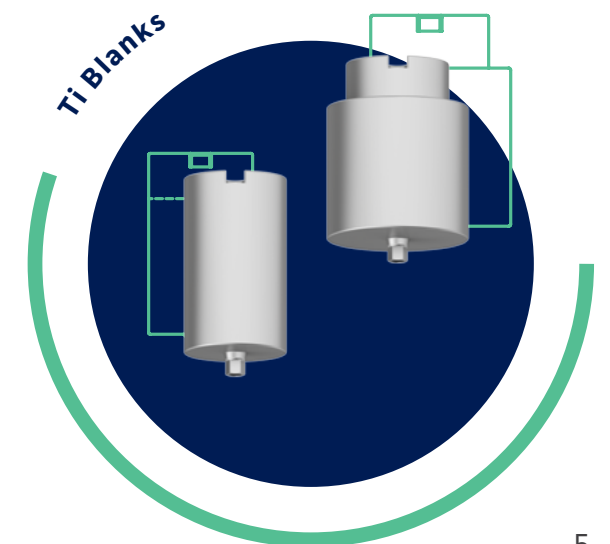

* Availability of the products in some places is limited and depends on local regulation. For more information, please contact your local representative



Ultra Narrow Platform for narrow ridges and tight spaces

Scan body | For Intra-oral and Desktop Scanner

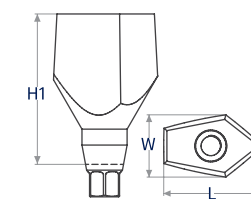

UNP CloseFit™
Scan Body 7mm



UNP CloseFit™
Scan Body 10mm



Catalog No.	UNP0088	UNP0089
Retaining Screw Included	UNP0001	UNP0001
Material	Ti 6Al 4V ELI	Ti 6Al 4V ELI
Dimensions	H1: 7 mm W: 4.2 mm L: 6.7 mm	H1: 10 mm W: 4.5 mm L: 6.9 mm

Ti Bases

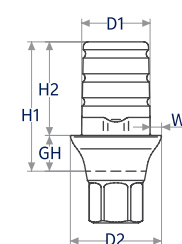

Engaged

UNP CloseFit™
Ti Base Engaged



Non Engaged

UNP CloseFit™
Ti Base Non Engaged

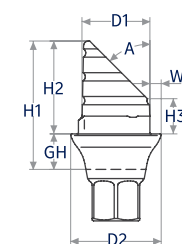

Angular Engaged

UNP CloseFit™
Ti Base Angular Engaged



Catalog No.	UNP1704	UNP1708
Retaining Screw Included	UNP0001	UNP0001
Material	Ti 6Al 4V ELI	Ti 6Al 4V ELI
Dimensions	H1: 5.4 mm H2: 3.9 mm — — D1: Ø2.9 mm D2: Ø3.8 mm W: 0.5 mm GH: 1.5 mm	H1: 5.4 mm H2: 3.9 mm — — D1: Ø2.9 mm D2: Ø3.8 mm W: 0.5 mm GH: 1.5 mm
Intended Use	Single Unit	Bridge

Catalog No.	UNP1717
Retaining Screw Included	UNP0001
Material	Ti 6Al 4V ELI
Dimensions	H1: 5.4 mm H2: 3.9 mm H3: 1.5 mm A: 45° D1: Ø2.9 mm D2: Ø3.8 mm W: 0.5 mm GH: 1.5 mm
Intended Use	Single Unit / Angle Correction

Ti Blanks* | For Medentika PreFace® Holders

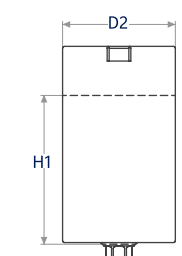

UNP CloseFit™
Ti Pre Milled MDTK
Abutment Blank
Ø11.5mm

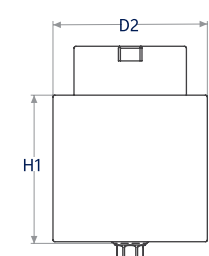

UNP CloseFit™
Ti Pre Milled MDTK
Abutment Blank
Ø15.8mm



Catalog No.	UNP1711	Catalog No.	UNP1715
Retaining Screw Included	UNP0001	Retaining Screw Included	UNP0001
Material	Ti 6Al 4V ELI	Material	Ti 6Al 4V ELI
Dimensions	H1: 15.4 mm D2: Ø11.5 mm	Dimensions	H1: 15.4 mm D2: Ø15.8 mm
Intended Use	customized abutment for single unit	Intended Use	customized abutment for single unit

*Ti Blanks will be available during Q1 of 2018.

CloseFit™ NP

Conical-Hex Connection

Ø3

Narrow Platform for narrow ridges and tight spaces

Scan body | For Intra-oral and Desktop Scanner

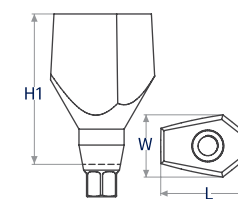

Catalog No.	NP0088	NP0089
Retaining Screw Included	NP0001	NP0001
Material	Ti 6Al 4V ELI	Ti 6Al 4V ELI
Dimensions	H1: 7 mm W: 4.2 mm L: 6.7 mm	H1: 10 mm W: 4.5 mm L: 6.9 mm

Ti Bases

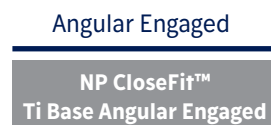
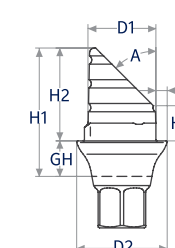
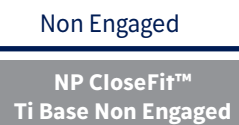
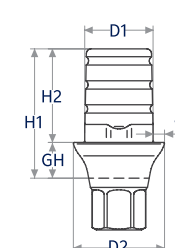

Catalog No.	NP1004	NP1008
Retaining Screw Included	NP0001	NP0001
Material	Ti 6Al 4V ELI	Ti 6Al 4V ELI
Dimensions	H1: 5.4 mm H2: 3.9 mm — — D1: Ø2.9 mm D2: Ø3.8 mm W: 0.5 mm GH: 1.5 mm	H1: 5.4 mm H2: 3.9 mm — — D1: Ø2.9 mm D2: Ø3.8 mm W: 0.5 mm GH: 1.5 mm
Intended Use	Single Unit	Bridge

Catalog No.	NP1017
Retaining Screw Included	NP0001
Material	Ti 6Al 4V ELI
Dimensions	H1: 5.4 mm H2: 3.9 mm H3: 1.5 mm A: 45° D1: Ø2.9 mm D2: Ø3.8 mm W: 0.5 mm GH: 1.5 mm
Intended Use	Single Unit / Angle Correction

Ti Blanks* | For Medentika PreFace® Holders

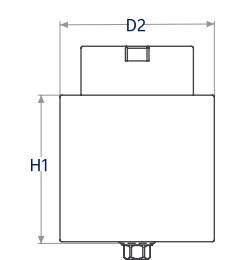
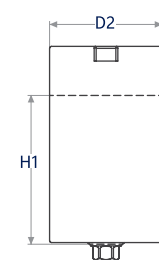

Catalog No.	NP1111	Catalog No.	NP1115
Retaining Screw Included	NP0001	Retaining Screw Included	NP0001
Material	Ti 6Al 4V ELI	Material	Ti 6Al 4V ELI
Dimensions	H1: 15.4 mm D2: Ø11.5 mm	Dimensions	H1: 15.4 mm D2: Ø15.8 mm
Intended Use	customized abutment for single unit	Intended Use	customized abutment for single unit

*Ti Blanks will be available during Q1 of 2018.

CloseFit™ RP

Conical-Hex Connection

Ø 3.5

Regular Platform for standard size ridges and spaces

Scan body | For Intra-oral and Desktop Scanner

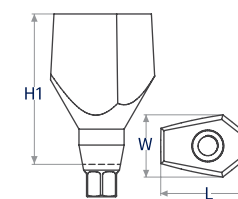

RP CloseFit™ Scan Body 7mm



RP CloseFit™ Scan Body 10mm



Catalog No.	RP0088	RP0089
Retaining Screw Included	RP0001	RP0001
Material	Ti 6Al 4V ELI	Ti 6Al 4V ELI
Dimensions	H1: 7 mm W: 4.3 mm L: 6.7 mm	H1: 10 mm W: 4.5 mm L: 6.9 mm

Ti Bases

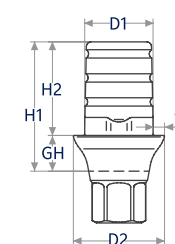

Engaged

RP CloseFit™ Ti Base Engaged



Non Engaged

RP CloseFit™ Ti Base Non Engaged

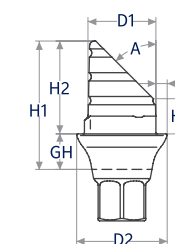
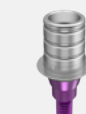

Angular Engaged

RP CloseFit™ Ti Base Angular Engaged

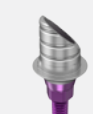

Catalog No.	RP1204	RP1208	Catalog No.	RP1217
Retaining Screw Included	RP0001	RP0001	Retaining Screw Included	RP0001
Material	Ti 6Al 4V ELI	Ti 6Al 4V ELI	Material	Ti 6Al 4V ELI
Dimensions	H1: 4.9 mm H2: 3.9 mm — — D1: Ø3.3 mm D2: Ø4.5 mm W: 0.6 mm GH: 1.0 mm	H1: 4.9 mm H2: 3.9 mm — — D1: Ø3.3 mm D2: Ø4.5 mm W: 0.6 mm GH: 1.0 mm	Dimensions	H1: 4.9 mm H2: 3.9 mm H3: 1.5 mm A: 48° D1: Ø3.3 mm D2: Ø4.5 mm W: 0.6 mm GH: 1.0 mm
Intended Use	Single Unit	Bridge	Intended Use	Single Unit / Angle Correction

Ti Blanks* | For Medentika PreFace® Holders

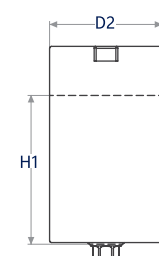

RP CloseFit™ Ti Pre Milled MDTK Abutment Blank Ø11.5mm

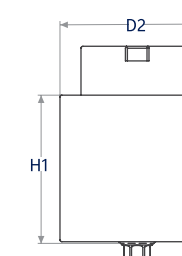

RP CloseFit™ Ti Pre Milled MDTK Abutment Blank Ø15.8mm



Catalog No.	RP1211	Catalog No.	RP1215
Retaining Screw Included	RP0001	Retaining Screw Included	RP0001
Material	Ti 6Al 4V ELI	Material	Ti 6Al 4V ELI
Dimensions	H1: 15.2 mm D2: Ø11.5 mm	Dimensions	H1: 15.2 mm D2: Ø15.8 mm
Intended Use	customized abutment for single unit	Intended Use	customized abutment for single unit

*Ti Blanks will be available during Q1 of 2018.



CloseFit™ WP

Conical-Hex Connection

Ø4.3 Ø5

Wide Platform for wide / large ridges and spaces

Scan body | For Intra-oral and Desktop Scanner

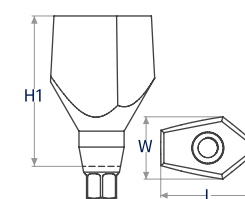

WP CloseFit™ Scan Body 7mm



WP CloseFit™ Scan Body 10mm



Catalog No.	WP0088	WP0089
Retaining Screw Included	WP0001	WP0001
Material	Ti 6Al 4V ELI	Ti 6Al 4V ELI
Dimensions	H1: 7 mm W: 4.3 mm L: 6.7 mm	H1: 10 mm W: 4.5 mm L: 6.9 mm

Ti Bases

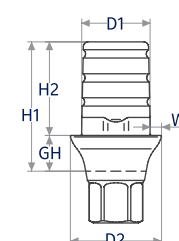

Engaged

WP CloseFit™ Ti Base Engaged



Non Engaged

WP CloseFit™ Ti Base Non Engaged

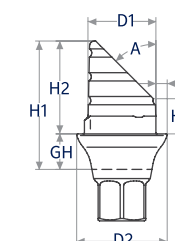

Angular Engaged

WP CloseFit™ Ti Base Angular Engaged



Catalog No.	WP1304	WP1308	Catalog No.	WP1317
Retaining Screw Included	WP0001	WP0001	Retaining Screw Included	WP0001
Material	Ti 6Al 4V ELI	Ti 6Al 4V ELI	Material	Ti 6Al 4V ELI
Dimensions	H1: 4.7 mm H2: 3.9 mm — — D1: Ø3.5 mm D2: Ø4.5 mm W: 0.5 mm GH: 0.8 mm	H1: 4.7 mm H2: 3.9 mm — — D1: Ø3.5 mm D2: Ø4.5 mm W: 0.5 mm GH: 0.8 mm	Dimensions	H1: 4.7 mm H2: 3.9 mm H3: 1.5 mm A: 51.5° D1: Ø3.5 mm D2: Ø4.5 mm W: 0.5 mm GH: 0.8 mm
Intended Use	Single Unit	Bridge	Intended Use	Single Unit / Angle Correction

Ti Blanks* | For Medentika PreFace® Holders

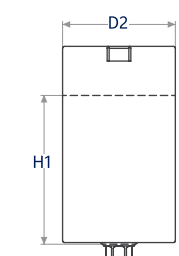

WP CloseFit™ Ti Pre Milled MDTK Abutment Blank Ø11.5mm

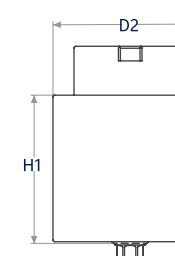

WP CloseFit™ Ti Pre Milled MDTK Abutment Blank Ø15.8mm



Catalog No.	WP1311	Catalog No.	WP1315
Retaining Screw Included	WP0001	Retaining Screw Included	WP0001
Material	Ti 6Al 4V ELI	Material	Ti 6Al 4V ELI
Dimensions	H1: 15.2 mm D2: Ø11.5 mm	Dimensions	H1: 15.2 mm D2: Ø15.8 mm
Intended Use	customized abutment for single unit	Intended Use	customized abutment for single unit

*Ti Blanks will be available during Q1 of 2018.



Touareg-S™, Touareg-OS™, Swell™, Triple™

Scan body | For Intra-oral and Desktop Scanner

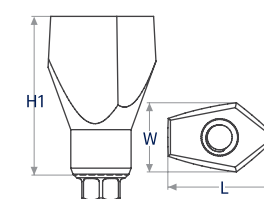

	RS Scan Body 7mm	RS Scan Body 10mm
Catalog No.	RS0088	RS0089
Retaining Screw Included	RS3400	RS3425
Material	Ti 6Al 4V ELI	Ti 6Al 4V ELI
Dimensions	H1: 7 mm W: 4.3 mm L: 6.7 mm	H1: 10 mm W: 4.4 mm L: 6.8 mm

Ti Bases

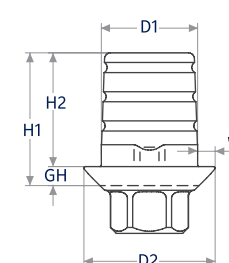

	Engaged	Non Engaged
	RS Ti Base Engaged	RS Ti Base Non Engaged
Catalog No.	RS1404	RS1408
Retaining Screw Included	RS3402	RS3402
Material	Ti 6Al 4V ELI	Ti 6Al 4V ELI
Dimensions	H1: 4.6 mm H2: 3.9 mm — — D1: Ø3.3 mm D2: Ø4.5 mm W: 0.6 mm GH: 0.7 mm	H1: 4.6 mm H2: 3.9 mm — — D1: Ø3.3 mm D2: Ø4.5 mm W: 0.6 mm GH: 0.7 mm
Intended Use	Single Unit	Bridge

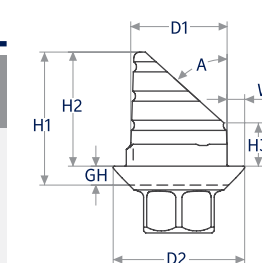

	Angular Engaged
	RS Ti Base Angular Engaged
Catalog No.	RS1417
Retaining Screw Included	RS3402
Material	Ti 6Al 4V ELI
Dimensions	H1: 4.6 mm H2: 3.9 mm H3: 1.5 mm A: 48° D1: Ø3.3 mm D2: Ø4.5 mm W: 0.6 mm GH: 0.7 mm
Intended Use	Single Unit / Angle Correction

Ti Blanks* | For Medentika PreFace® Holders

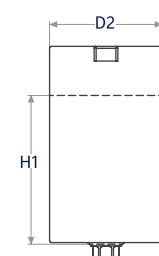

	RS Ti Pre Milled MDTK Abutment Blank Ø11.5mm
Catalog No.	RS1411
Retaining Screw Included	RS3402
Material	Ti 6Al 4V ELI
Dimensions	H1: 15.2 mm D2: Ø11.5 mm
Intended Use	customized abutment for single unit

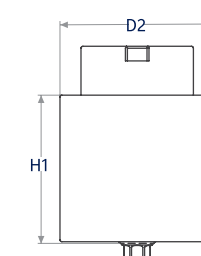

	RS Ti Pre Milled MDTK Abutment Blank Ø15.8mm
Catalog No.	RS1415
Retaining Screw Included	RS3402
Material	Ti 6Al 4V ELI
Dimensions	H1: 15.2 mm D2: Ø15.8 mm
Intended Use	customized abutment for single unit

*Ti Blanks will be available during Q1 of 2018.

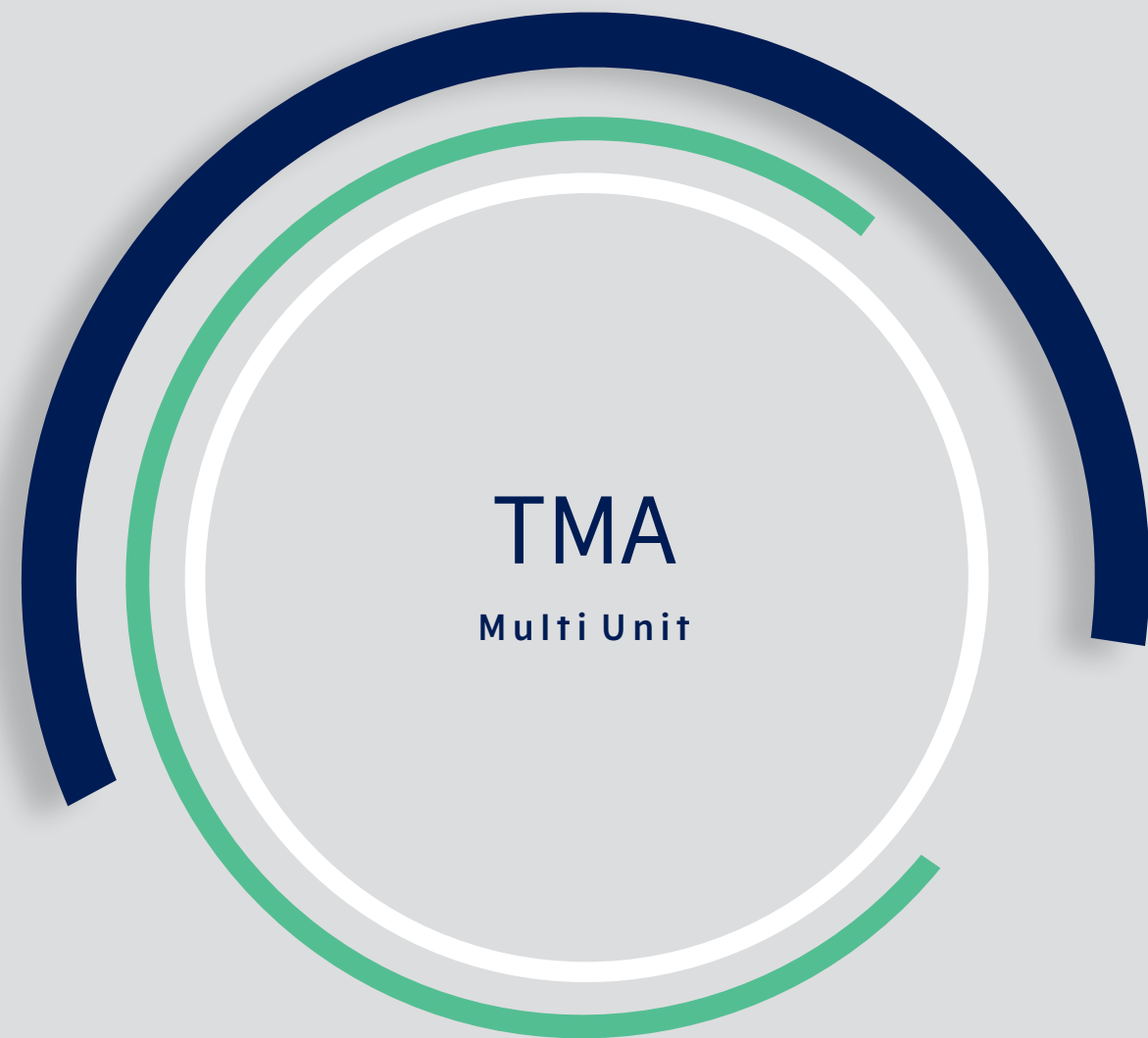

TMA
Multi Unit

For Screw Retained Restoration

Scan body | For Intra-oral and Desktop Scanner

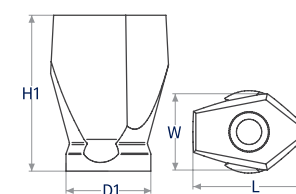

TMA
Scan Body 6mm



TMA
Scan Body 9mm



Catalog No.	TM0006	TM0009
Retaining Screw Included	TM0001	TM0001
Material	Ti 6Al 4V ELI	Ti 6Al 4V ELI
Dimensions	H1: 6 mm D1: Ø4.9 mm W: 4.3 mm L: 6.7 mm	H1: 9 mm D1: Ø4.9 mm W: 4.5 mm L: 6.8 mm

Cementing Cone & Cylinder

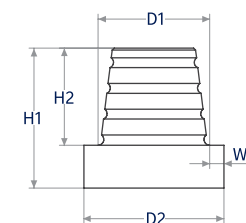

TMA
Cementing Cone

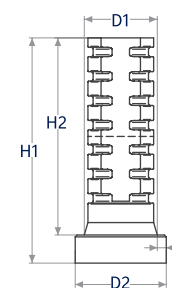

Titanium
Temporary Cylinder







Catalog No.	TM0010	Catalog No.	RS4900
Retaining Screw Included	TM0001	Retaining Screw Included	RS3404
Material	Ti 6Al 4V ELI	Material	Ti 6Al 4V ELI
Dimensions	H1: 4.9 mm H2: 3.4 mm D1: Ø3.8 mm D2: Ø4.9 mm W: 0.5 mm	Dimensions	H1: 12 mm H2: 10.5 mm D1: Ø3.9 mm D2: Ø4.9 mm W: 0.5 mm

Accessories



Screws, Tools, Analogs & Replica

Screws



CloseFit™





	UNP CloseFit™ Abutment Screw	NP CloseFit™ Abutment Screw	RP CloseFit™ Abutment Screw	WP CloseFit™ Abutment Screw
				
Catalog No.	UNP0001	NP0001	RP0001	WP0001
Material	Ti 6Al 4V ELI	Ti 6Al 4V ELI	Ti 6Al 4V ELI	Ti 6Al 4V ELI
Intended use	For UNP Scan Body, Ti Bases and Blanks	For NP Scan Body, Ti Bases and Blanks	For RP Scan Body, Ti Bases and Blanks	For WP Scan Body, Ti Bases and Blanks



Touareg™ RS



	RS Prosthetic Screw	RS Screw For Closed Tray Transfer	RS Short Prosthetic Screw
			
Catalog No.	RS3400	RS3425	RS3402
Material	Ti 6Al 4V ELI	Ti 6Al 4V ELI	Ti 6Al 4V ELI
Intended use	For RS Scan Body 7mm	For RS Scan Body 10mm	For RS Ti Bases and Ti Blanks

TMA - Multi Unit

	TMA Scan Body Screw	TMA Prosthetic Screw
		
Catalog No.	TM0001	RS3404
Material	Ti 6Al 4V ELI	Ti 6Al 4V ELI
Intended use	For TMA-MU Scan Body and Cementing Cone	For TMA-MU Temporary cylinder and TMA direct option

Analogs & Replica*				
CloseFit™				
	UNP Implant Analog	NP Implant Analog	RP Implant Analog	WP Implant Analog
				
Catalog No.	UNP0007	NP0007	RP0007	WP0007
Material	TI 6Al 4V ELI	TI 6Al 4V ELI	TI 6Al 4V ELI	TI 6Al 4V ELI

RS and TMA- MU		
	RS Internal Hex Implant Analog	TMA Abutment Replica
		
Catalog No.	RS5737	RS5004
Material	TI 6Al 4V ELI	TI 6Al 4V ELI

Tools		
	Star Hand driver- Short	1.27 Hex Hand Driver- Short
		
Catalog No.	RP0064	RS6095
	Star Hand driver- Long	1.27 Hex Hand Driver- Medium
Catalog No.	RP0004	RS6094
Intended use	Compatible with TMA-MU and CloseFit™ Platforms: UNP, NP, RP, WP	Compatible with Touareg™ RS System: Touareg-S™, Touareg-OS™, Swell™, Triple™

*You may also use any of the following:

RS6097	RP0065
RS6080	RP0005
RS6082	RP0018
RS9030	RP0019
RS9035	RS5737 (MU)



Digital Libraries

CAD CAM libraries allow for design and manufacture of custom restoration products that fit Adin's implants using CAD CAM Technology.

Adin's CAD CAM restoration parts have been added to the Exocad, 3shape, Dental Wings, and are available for downloading on our website at: <https://www.adin-implants.com/product/cadcam/>

Adin may update its supported systems software list from time to time. The updated list will be available on Adin's website address mentioned above.

Features

- The use of CAD libraries for Temp restoration saves time and is much more accurate for both the doctor and the laboratory
- Titanium Temporary Cylinder (RS4900) was added to the 3D libraries in order to make the connection between the TMA and the temporary restoration
- Two different lengths of restoration were added to the libraries: Half High cylinder/ Full High cylinder
- Different options for cement were added to the libraries: 0.25 / 0.5 Cement Gap

The libraries contain

- Two Scan Body height variations fit all platforms: RS, WP, RP, NP, UNP and TMA-MU Platforms
- Ti bases: Engaged, Non-Engaged and Angular Engaged
- TMA Cementing cone and Temporary TMA restoration

Library installation instructions

Library files are available for downloading using the link above and are also accessible in the various software libraries.

After downloading our library, save the library files on your computer and follow your CAD CAM supplier loading and installation instructions in order to load and install our libraries onto your system.



Alphabetical Index

Catalog No.	Description	Page No.	Catalog No.	Description	Page No.
RS6094	1.27 Hex Hand Driver- Medium	20			
RS6095	1.27 Hex Hand Driver- Short	20			
N			S		
NP0001	NP Abutment Screw	9,19	RP0004	Star Hand driver- Long	20
NP0089	NP CloseFit™ Scan Body 10mm	9	RP0064	Star Hand driver- Short	20
NP0088	NP CloseFit™ Scan Body 7mm	9	T		
NP1017	NP CloseFit™ Ti Base Angular Engaged	9	RS4900	Titanium Temporary Cylinder	17
NP1004	NP CloseFit™ Ti Base Engaged	9	RS5004	TMA Abutment Replica	20
NP1008	NP CloseFit™ Ti Base Non Engaged	9	TM0010	TMA Cementing Cone	17
NP1111	NP CloseFit™ Ti Pre Milled MDTK Abutment Blank ø11.5mm	9	RS3404	TMA Prosthetic Screw	17,19
NP1115	NP CloseFit™ Ti Pre Milled MDTK Abutment Blank ø15.8mm	9	TM0006	TMA Scan Body 6mm	17
NP0007	NP Implant Analog	20	TM0009	TMA Scan Body 9mm	17
R			TM0001	TMA Scan Body Screw	17,19
RP0001	RP Abutment Screw	11,19	U		
RP0089	RP CloseFit™ Scan Body 10mm	11	UNP0001	UNP CloseFit™ Abutment Screw	7,19
RP0088	RP CloseFit™ Scan Body 7mm	11	UNP0089	UNP CloseFit™ Scan Body 10mm	7
RP1217	RP CloseFit™ Ti Base Angular Engaged	11	UNP0088	UNP CloseFit™ Scan Body 7mm	7
RP1204	RP CloseFit™ Ti Base Engaged	11	UNP1717	UNP CloseFit™ Ti Base Angular Engaged	7
RP1208	RP CloseFit™ Ti Base Non Engaged	11	UNP1704	UNP CloseFit™ Ti Base Engaged	7
RP1211	RP CloseFit™ Ti Pre Milled MDTK Abutment Blank ø11.5mm	11	UNP1708	UNP CloseFit™ Ti Base Non Engaged	7
RP1215	RP CloseFit™ Ti Pre Milled MDTK Abutment Blank ø15.8mm	11	UNP1711	UNP CloseFit™ Ti Pre Milled MDTK Abutment Blank ø11.5mm	7
RP0007	RP Implant Analog	20	UNP1715	UNP CloseFit™ Ti Pre Milled MDTK Abutment Blank ø15.8mm	7
RS5737	RS Internal Hex Implant Analog	20	UNP0007	UNP Implant Analog	20
RS3400	RS Prosthetic Screw	15,19	W		
RS0089	RS Scan Body 10mm	15	WP0001	WP Abutment Screw	13,19
RS0088	RS Scan Body 7mm	15	WP0089	WP CloseFit™ Scan Body 10mm	13
RS3425	RS Screw For Closed Tray Transfer	15,19	WP0088	WP CloseFit™ Scan Body 7mm	13
RS3402	RS Short Prosthetic Screw	15,19	WP1317	WP CloseFit™ Ti Base Angular Engaged	13
RS1417	RS Ti Base Angular Engaged	15	WP1304	WP CloseFit™ Ti Base Engaged	13
RS1404	RS Ti Base Engaged	15	WP1308	WP CloseFit™ Ti Base Non Engaged	13
RS1408	RS Ti Base Non Engaged	15	WP1311	WP CloseFit™ Ti Pre Milled MDTK Abutment Blank ø11.5mm	13
RS1411	RS Ti Pre Milled MDTK Abutment Blank ø11.5mm	15	WP1315	WP CloseFit™ Ti Pre Milled MDTK Abutment Blank ø15.8mm	13
RS1415	RS Ti Pre Milled MDTK Abutment Blank ø15.8mm	15	WP0007	WP Implant Analog	20

Numerical Index

Catalog No.	Description	Page No.	Catalog No.	Description	Page No.
NP0001	NP Abutment Screw	9,19	RS3404	TMA Prosthetic Screw	17,19
NP0007	NP Implant Analog	20	RS3425	RS Screw For Closed Tray Transfer	15,19
NP0088	NP CloseFit™ Scan Body 7mm	9	RS4900	Titanium Temporary Cylinder	17
NP0089	NP CloseFit™ Scan Body 10mm	9	RS5004	TMA Abutment Replica	20
NP1004	NP CloseFit™ Ti Base Engaged	9	RS5737	RS Internal Hex Implant Analog	20
NP1008	NP CloseFit™ Ti Base Non Engaged	9	RS6094	1.27 Hex Hand Driver- Medium	20
NP1017	NP CloseFit™ Ti Base Angular Engaged	9	RS6095	1.27 Hex Hand Driver- Short	20
NP1111	NP CloseFit™ Ti Pre Milled MDTK Abutment Blank ø11.5mm	9	TM0001	TMA Scan Body Screw	17,19
NP1115	NP CloseFit™ Ti Pre Milled MDTK Abutment Blank ø15.8mm	9	TM0006	TMA Scan Body 6mm	17
RP0001	RP Abutment Screw	11,19	TM0009	TMA Scan Body 9mm	17
RP0004	Star Hand driver- Long	20	TM0010	TMA Cementing Cone	17
RP0007	RP Implant Analog	20	UNP0001	UNP CloseFit™ Abutment Screw	7,19
RP0064	Star Hand driver- Short	20	UNP0007	UNP Implant Analog	20
RP0088	RP CloseFit™ Scan Body 7mm	11	UNP0088	UNP CloseFit™ Scan Body 7mm	7
RP0089	RP CloseFit™ Scan Body 10mm	11	UNP0089	UNP CloseFit™ Scan Body 10mm	7
RP1204	RP CloseFit™ Ti Base Engaged	11	UNP1704	UNP CloseFit™ Ti Base Engaged	7
RP1208	RP CloseFit™ Ti Base Non Engaged	11	UNP1708	UNP CloseFit™ Ti Base Non Engaged	7
RP1211	RP CloseFit™ Ti Pre Milled MDTK Abutment Blank ø11.5mm	11	UNP1711	UNP CloseFit™ Ti Pre Milled MDTK Abutment Blank ø11.5mm	7
RP1215	RP CloseFit™ Ti Pre Milled MDTK Abutment Blank ø15.8mm	11	UNP1715	UNP CloseFit™ Ti Pre Milled MDTK Abutment Blank ø15.8mm	7
RP1217	RP CloseFit™ Ti Base Angular Engaged	11	UNP1717	UNP CloseFit™ Ti Base Angular Engaged	7
RS0088	RS Scan Body 7mm	15	WP0001	WP Abutment Screw	13,19
RS0089	RS Scan Body 10mm	15	WP0007	WP Implant Analog	20
RS1404	RS Ti Base Engaged	15	WP0088	WP CloseFit™ Scan Body 7mm	13
RS1408	RS Ti Base Non Engaged	15	WP0089	WP CloseFit™ Scan Body 10mm	13
RS1411	RS Ti Pre Milled MDTK Abutment Blank ø11.5mm	15	WP1304	WP CloseFit™ Ti Base Engaged	13
RS1415	RS Ti Pre Milled MDTK Abutment Blank ø15.8mm	15	WP1308	WP CloseFit™ Ti Base Non Engaged	13
RS1417	RS Ti Base Angular Engaged	15	WP1311	WP CloseFit™ Ti Pre Milled MDTK Abutment Blank ø11.5mm	13
RS3400	RS Prosthetic Screw	15,19	WP1315	WP CloseFit™ Ti Pre Milled MDTK Abutment Blank ø15.8mm	13
RS3402	RS Short Prosthetic Screw	15,19	WP1317	WP CloseFit™ Ti Base Angular Engaged	13



www.adin-implants.com

Industrial Park Alon Tavor, POB 1128, Afula 1811101, Israel
T. +972-4-6426732 | F. +972-4-6426733 | info@adin-implants.com